

Plan View showing fixing centres

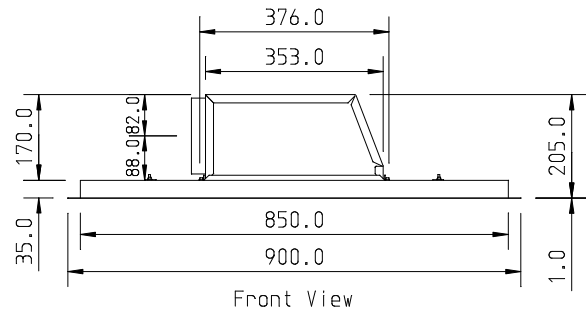

Front View

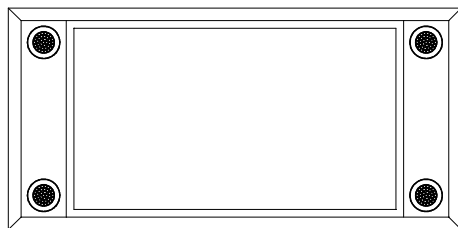

View from Underneath

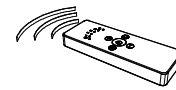

Radio Remote Control

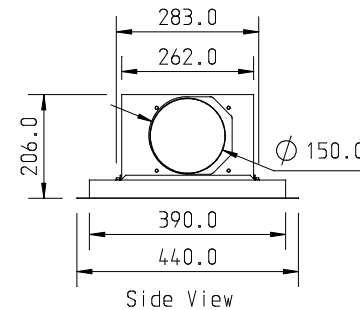

Side View

Cutout Details: Width 860 x Depth 400

Lighting: 4 x Cool White LED Lamps.

Duct Position: Left (factory default), Right, Front, Rear and Top.

The top box is easily separated from the baseplate and can be rotated through 180 degrees in order to achieve all possible outlet directions.

The ducting spigot must be set to the required outlet position prior to installation (see instruction manual).

The extractor is fitted with 4 high intensity LED lamp assemblies (one in each corner) which conceal the fixing holes behind them. These are easily popped out to reveal four possible fixing locations behind each.

Motor and lights are controlled via radio remote control.

Remote Motor Top Box Connections

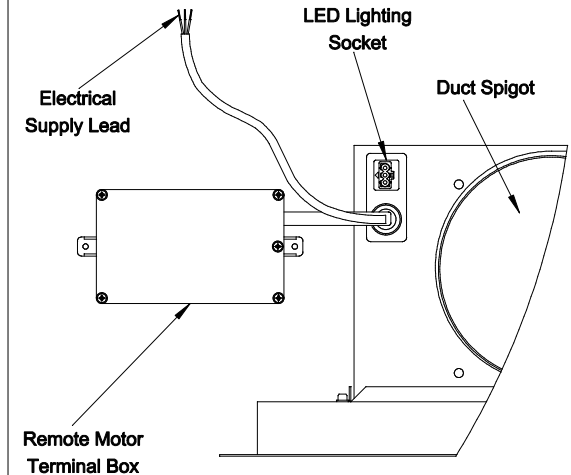

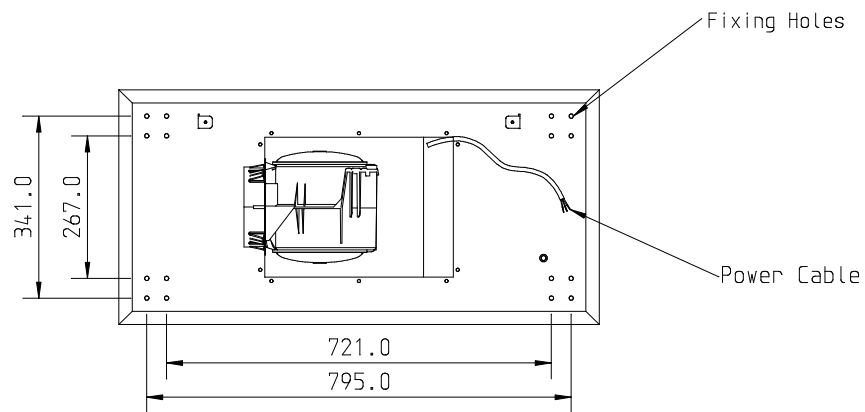

Plan View showing fixing centres

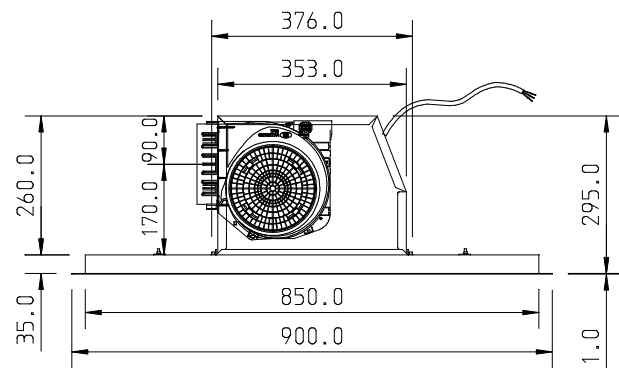

Front View

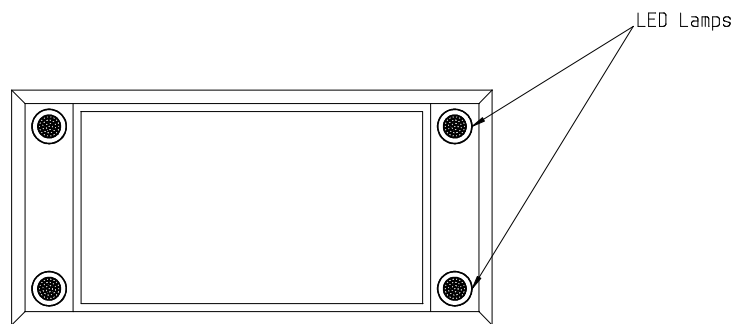

View from Underneath

Cutout Details: Width 860 x Depth 400

Lighting: 4 x Cool White LED Lamps.

Duct Position: Left (factory default), Right, Front, Rear and Top.

The top box is easily separated from the baseplate and can be rotated through 180 degrees in order to achieve all possible outlet directions.

The ducting spigot must be set to the required outlet position prior to installation (see instruction manual).

The extractor is fitted with 4 high intensity LED lamp assemblies (one in each corner) which conceal the fixing holes behind them. These are easily popped out to reveal four possible fixing locations behind each.

Motor and lights are controlled via radio remote control.

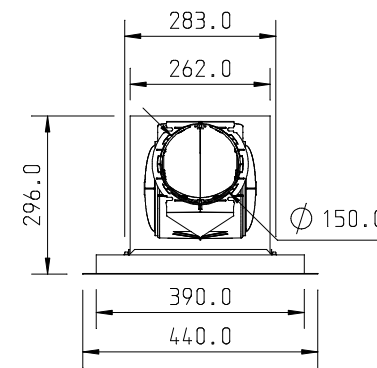

Side View

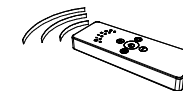

Radio Remote Control

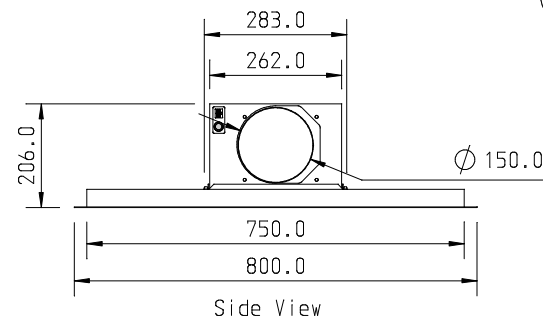
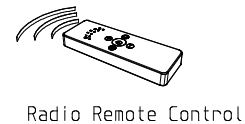
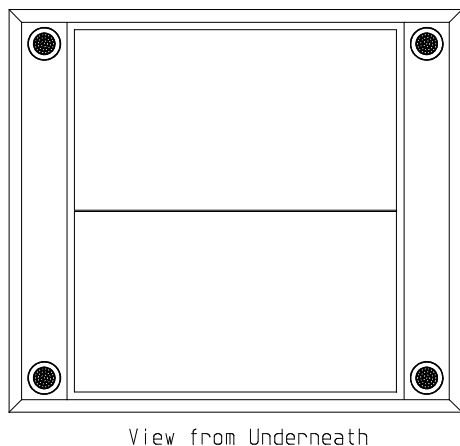
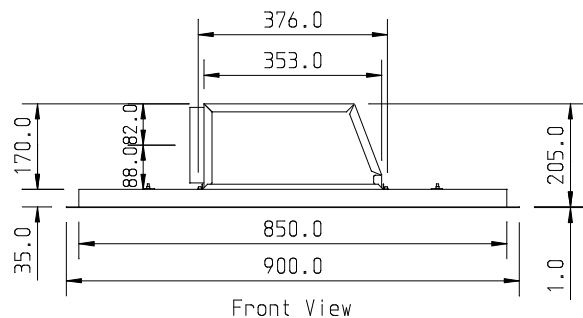
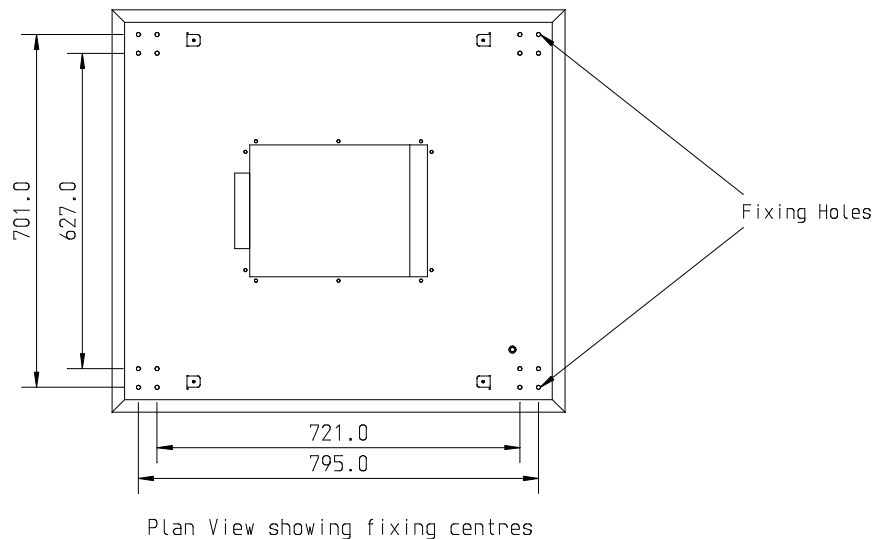

Remote Motor Top Box Connections

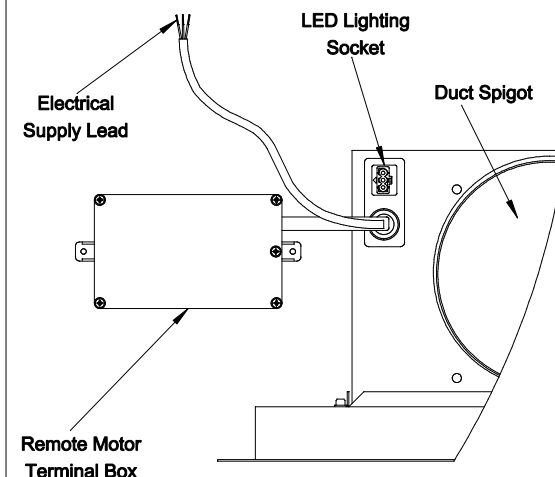

Cutout Details: Width 860 x Depth 760

Lighting: 4 x Cool White LED Lamps.

Duct Position: Left (factory default), Right, Front, Rear and Top.

The top box is easily separated from the baseplate and can be rotated through 180 degrees in order to achieve all possible outlet directions.

The ducting spigot must be set to the required outlet position prior to installation (see instruction manual).

The extractor is fitted with 4 high intensity LED lamp assemblies (one in each corner) which conceal the fixing holes behind them. These are easily popped out to reveal four possible fixing locations behind each.

Motor and lights are controlled via radio remote control.

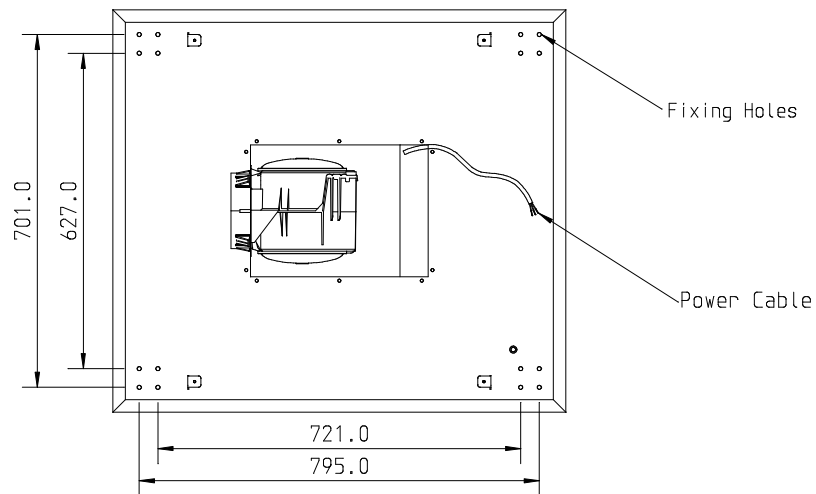

Plan View showing fixing centres

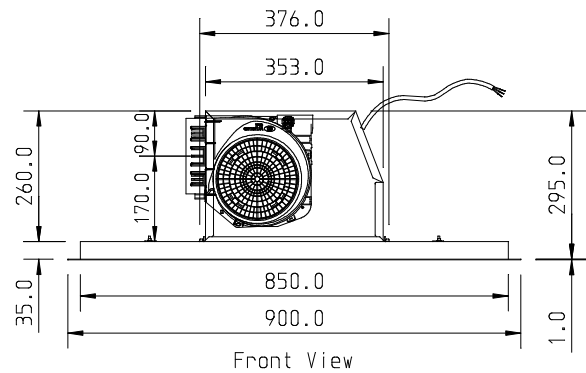

Front View

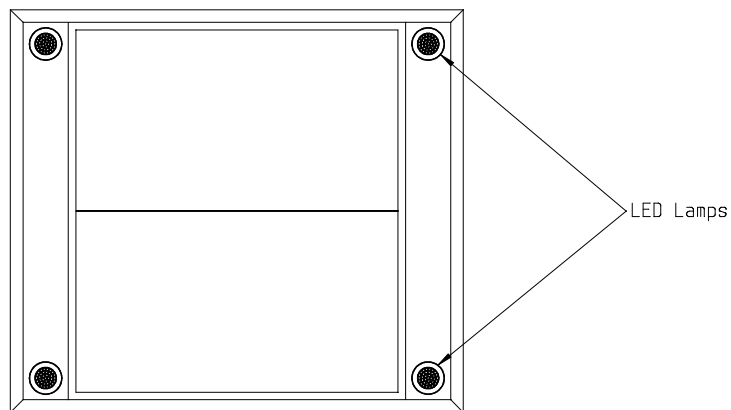

View from Underneath

Cutout Details: Width 860 x Depth 760

Lighting: 4 x Cool White LED Lamps.

Duct Position: Left (factory default), Right, Front, Rear and Top.

The top box is easily separated from the baseplate and can be rotated through 180 degrees in order to achieve all possible outlet directions.

The ducting spigot must be set to the required outlet position prior to installation (see instruction manual).

The extractor is fitted with 4 high intensity LED lamp assemblies (one in each corner) which conceal the fixing holes behind them. These are easily popped out to reveal four possible fixing locations behind each.

Motor and lights are controlled via radio remote control.

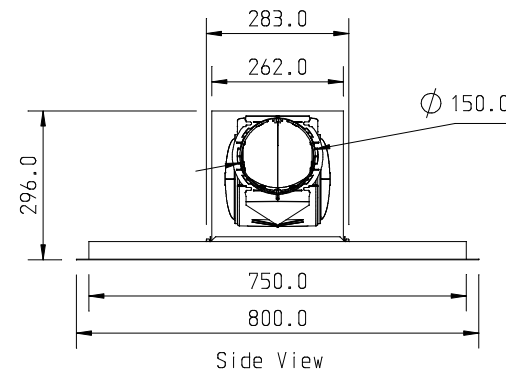

Side View

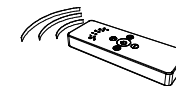

Radio Remote Control

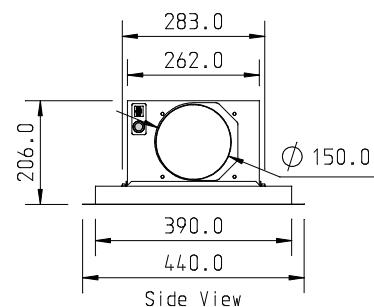
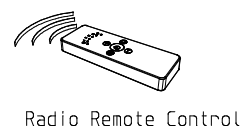
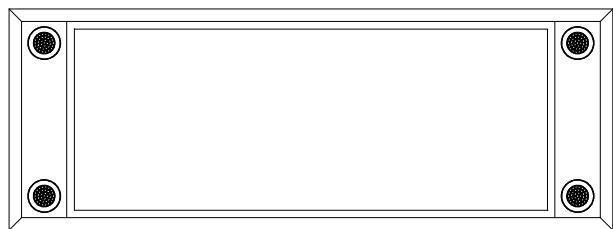
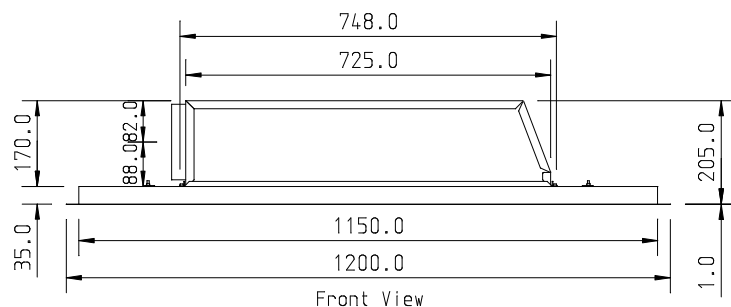
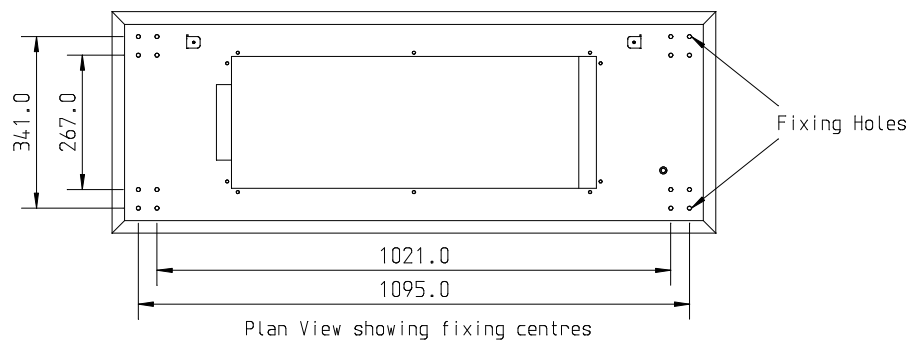

Remote Motor Top Box Connections

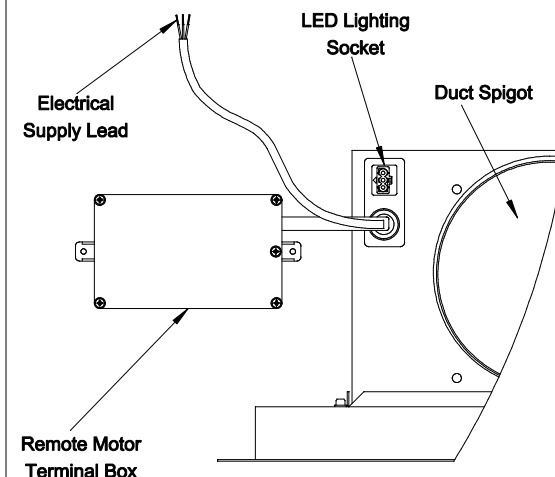

Cutout Details: Width 1160 x Depth 400

Lighting: 4 x Cool White LED Lamps.

Duct Position: Left (factory default), Right, Front, Rear and Top.

The top box is easily separated from the baseplate and can be rotated through 180 degrees in order to achieve all possible outlet directions.

The ducting spigot must be set to the required outlet position prior to installation (see instruction manual).

The extractor is fitted with 4 high intensity LED lamp assemblies (one in each corner) which conceal the fixing holes behind them. These are easily popped out to reveal four possible fixing locations behind each.

Motor and lights are controlled via radio remote control.

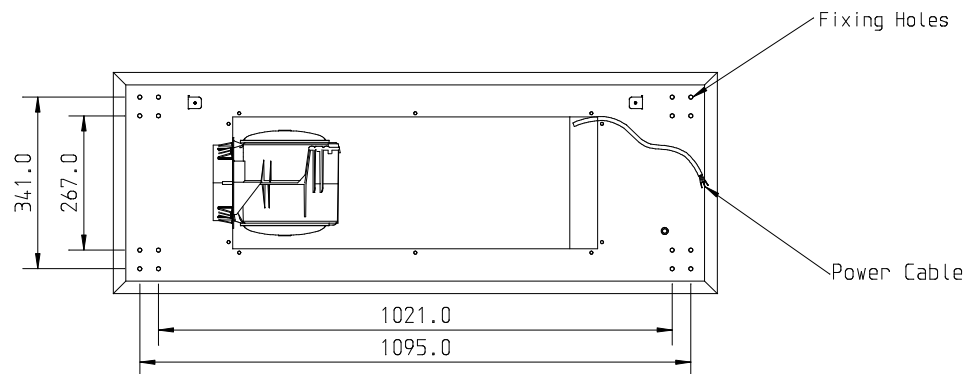

Plan View showing fixing centres

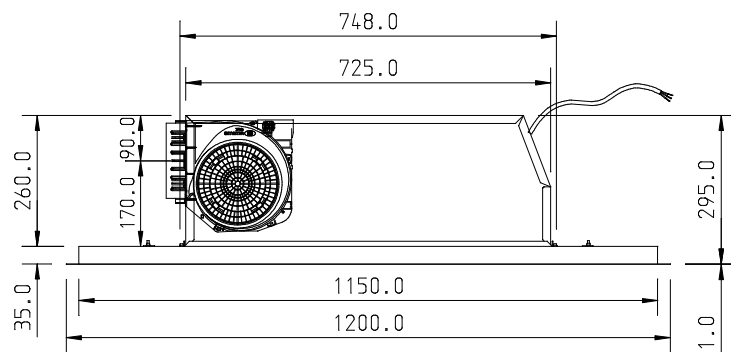

Front View

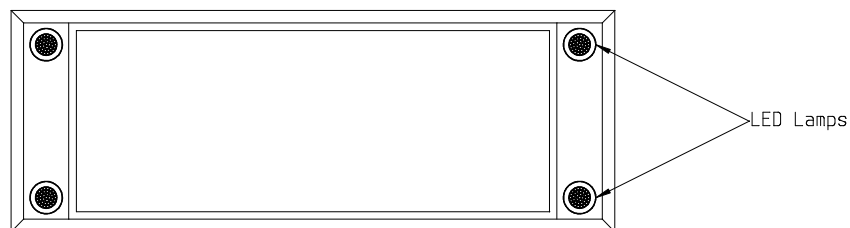

View from Underneath

Cutout Details: Width 1160 x Depth 400

Lighting: 4 x Cool White LED Lamps.

Duct Position: Left (factory default), Right, Front, Rear and Top.

The top box is easily separated from the baseplate and can be rotated through 180 degrees in order to achieve all possible outlet directions.

The ducting spigot must be set to the required outlet position prior to installation (see instruction manual).

The extractor is fitted with 4 high intensity LED lamp assemblies (one in each corner) which conceal the fixing holes behind them. These are easily popped out to reveal four possible fixing locations behind each.

Motor and lights are controlled via radio remote control.

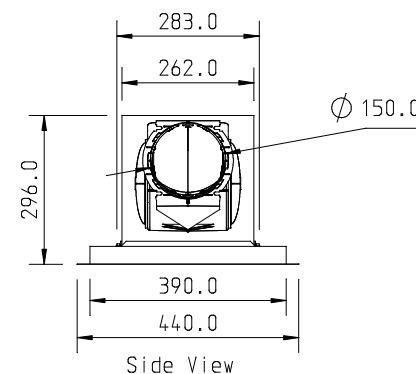

Side View

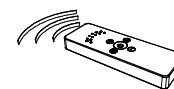

Radio Remote Control

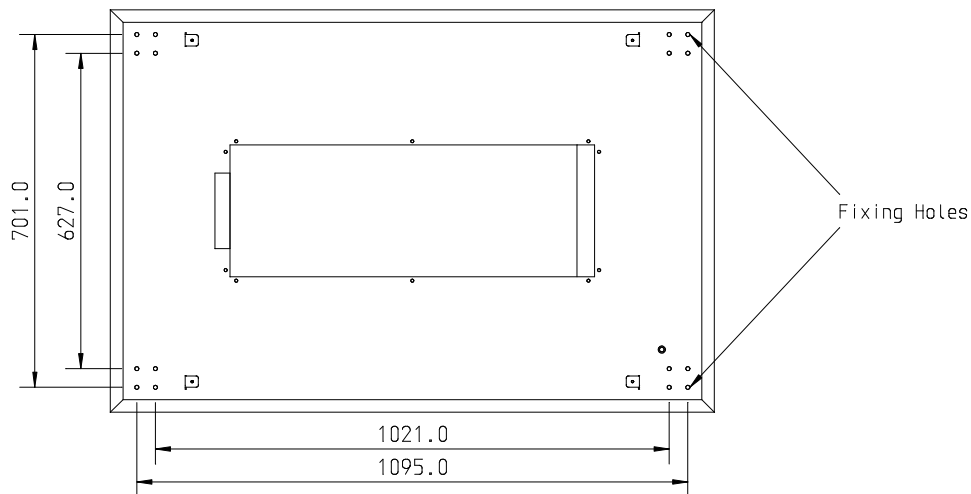

Plan View showing fixing centres

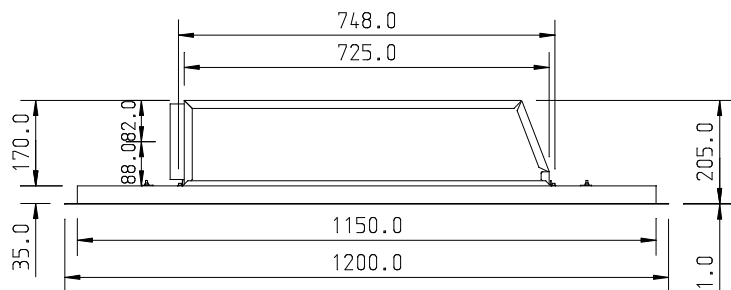

Front View

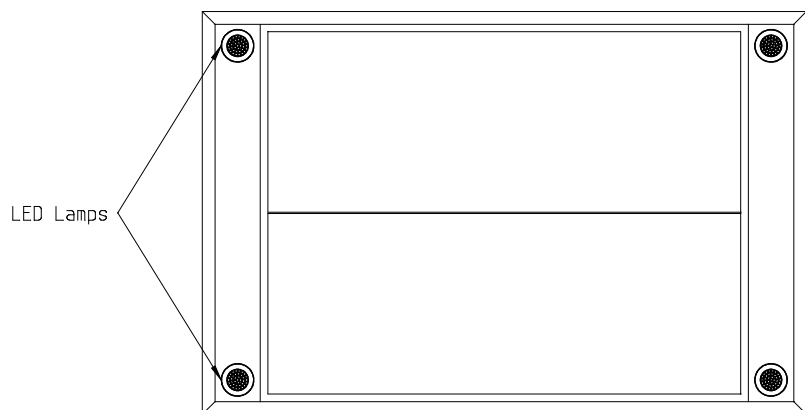

View from Underneath

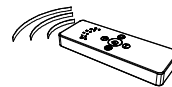

Radio Remote Control

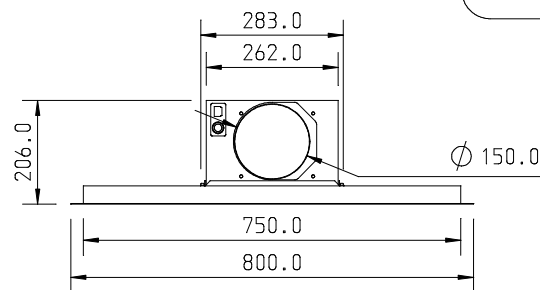

Side View

Remote Motor Top Box Connections

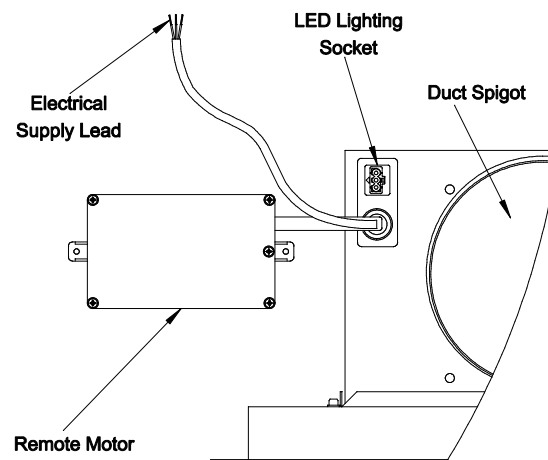

Cutout Details: Width 1160 x Depth 760

Lighting: 4 x Cool White LED Lamps.

Duct Position: Left (factory default), Right, Front, Rear and Top.

The top box is easily separated from the baseplate and can be rotated through 180 degrees in order to achieve all possible outlet directions.

The ducting spigot must be set to the required outlet position prior to installation (see instruction manual).

The extractor is fitted with 4 high intensity LED lamp assemblies (one in each corner) which conceal the fixing holes behind them. These are easily popped out to reveal four possible fixing locations behind each.

Motor and lights are controlled via radio remote control.

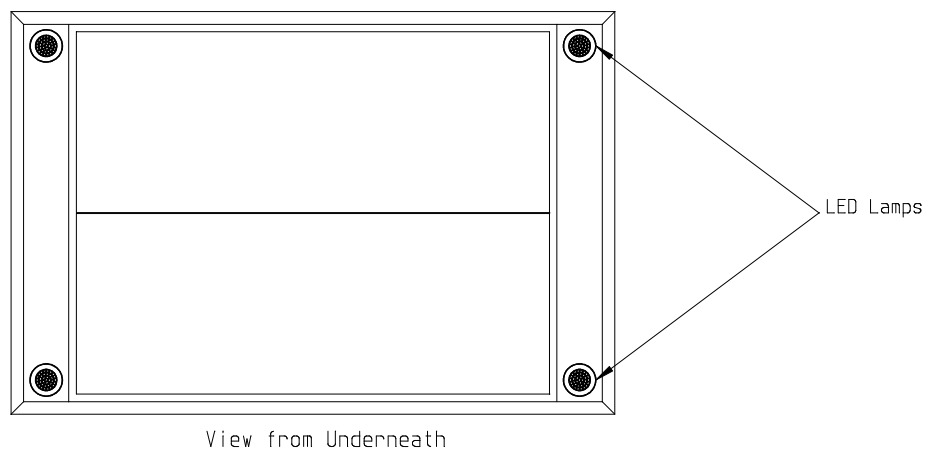
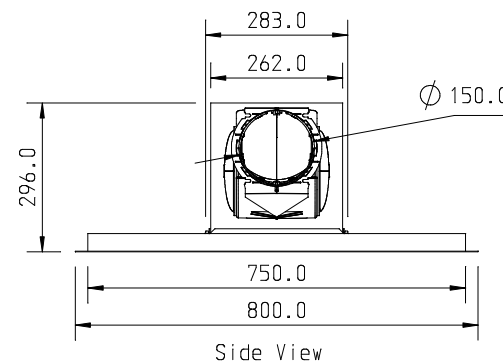
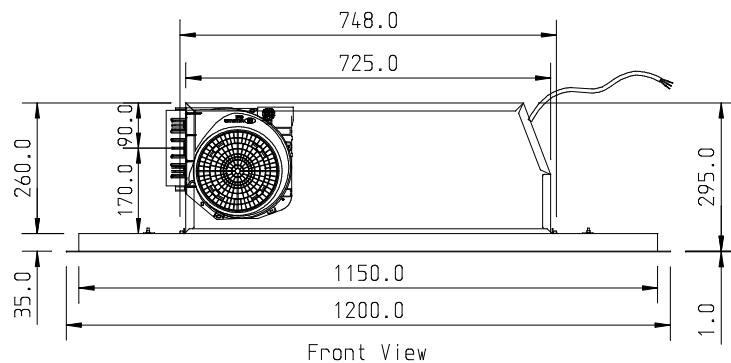
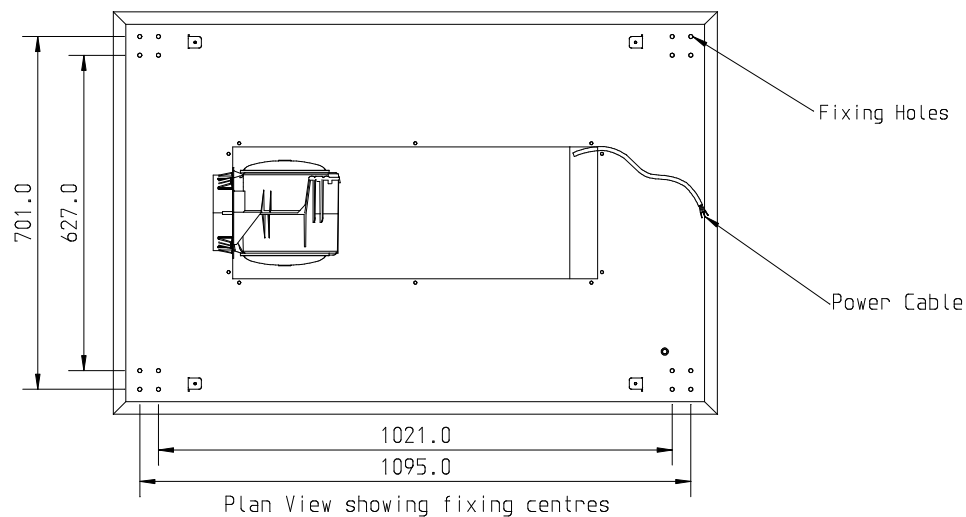

Cutout Details: Width 1160 x Depth 760

Lighting: 4 x Cool White LED Lamps.

Duct Position: Left (factory default), Right, Front, Rear and Top.

The top box is easily separated from the baseplate and can be rotated through 180 degrees in order to achieve all possible outlet directions.

The ducting spigot must be set to the required outlet position prior to installation (see instruction manual).

The extractor is fitted with 4 high intensity LED lamp assemblies (one in each corner) which conceal the fixing holes behind them. These are easily popped out to reveal four possible fixing locations behind each.

Motor and lights are controlled via radio remote control.

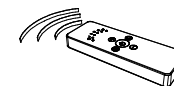

Radio Remote Control